

RENT • LEASE • PURCHASE

# Multi-Vac™



**Your Complete Industrial Vacuum Source**

# Multi-Vac Your Complete

## Exclusive Features And Key Benefits

Multi-Vac vacuum loaders are engineered to provide long service life with minimal maintenance attention! Consider these important factors:

- With Multi-Vac units, the dust collector bottom is open to the hopper with no internal baffles or ledges to create bridging and retard the flow of collected material into the hopper. In addition, this greatly reduces the cross contamination when handling different products.
- Multi-Vac is fitted with a positive displacement vacuum pump. As suction increases with increased material flow, Multi-Vac develops only the power required to move the material. The maximum vacuum generated is 16" hg. This is enough to flow material yet remains within the specifications of the vacuum pump manufacturers.
- By using conservative design standards with all our components we have produced a machine which will have a superior operating life span and require minimum maintenance. Consequently a 2 year warranty is furnished with all Multi-Vac Systems.
- Multi-Vac is made completely in our plant in the U.S.A. This allows us greater quality control. In addition, when custom specifications are needed, we are here to work with you.



No matter the need, you are sure to find a Multi-Vac that is perfect for your application.



### Dual Inlets™

Each Multi-Vac comes standard with Dual Inlets. This feature allows for more flexible machine placement and the added convenience of allowing left or right hand pick-up.



### No Tools Required<sup>SM</sup> Filter/Cage Removal

When service is required, our **No Tools Required** system provides immediate access to and immediate removal and replacement of filters and cages. These features can save hours over some older designs.



**Super Mini Series**  
Page 5



**Mini Series**  
Page 6



**Millennium Series**  
Page 7



**Stationary Systems**  
Page 8

# Industrial Vacuum Source!

See Page 11 For Optional Accessories

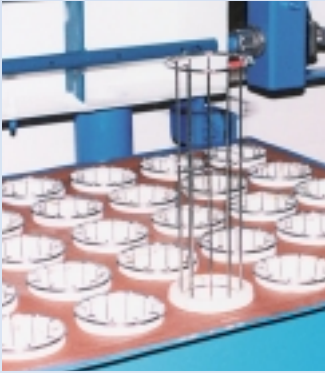

**Multi-Vac  
Bag Filters/Cages**

Multi-Vac Bag Filters have been proven on the widest range of materials from abrasive to high temperature and offer fast replacement. Bag Filters have no pleats to plug or bridge over which is a common problem with more costly cartridges.

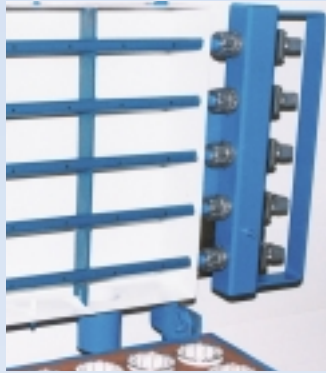

**Reverse Pulse Jet  
Filter Cleaning**

Multi-Vac is equipped with an "on demand" programmable reverse pulse jet filter cleaning system for continuous operation. Multi-Vac also has a manual push-button system for offline filter cleaning.



**Guarded Cam-Roll™  
Air Lift System**

Hopper changing is quick and easy using our Guarded Cam-Roll Air Lift System. The ease of hopper removal keeps downtime to a minimum.



**Built In  
Level Probe**

A built in level probe shuts the unit down whenever the hopper is full. A liquid high level probe is also available as an option when working with liquids.

**Contact Us For More Information Or A Quote**

**Toll-Free 1-800-640-4213 • [www.multivacinc.com](http://www.multivacinc.com)**

21209 Durand Avenue • Union Grove, WI 53182-9711

Tel: 262-878-0366 • Fax: 262-878-0368



**Intercept  
Hoppers**  
Page 8



**Trailer  
Units**  
Page 9



**Conversion Units  
and Upgrades**  
Page 10

## How It Works...

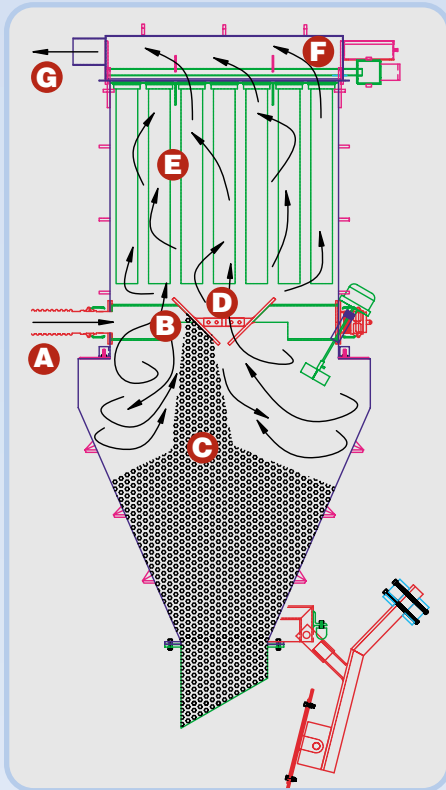

- A.** Material is picked up via a Multi-Vac Air Bleed Nozzle at a nozzle velocity of 4,000 to 7,000 feet per minute based on bulk density of your product.
- B.** The product impacts the abrasion resistant target deflector.
- C.** The heavy product drops from the air stream into the vacuum tight collection hopper.
- D.** Now only dust-laden air travels vertically at a can velocity of approximately 40 to 175 feet per minute. Special attention in this area insures long filter life that will give long vacuum pump life.
- E.** Air born dust is collected on the outside of the filter media.
- F.** The “on demand” programmable reverse pulse jet filter cleaning system ensures continuous operation—the machine does not have to be shutdown for filter cleaning.
- G.** Clean air then passes in the vacuum pump inlet.

The discharge air then passes through a large silencer located in a modular Power Pack.™

## Versatile Use In Multiple Applications

### Stationary Vacuum System Manifold Discharging Into A Super Sack

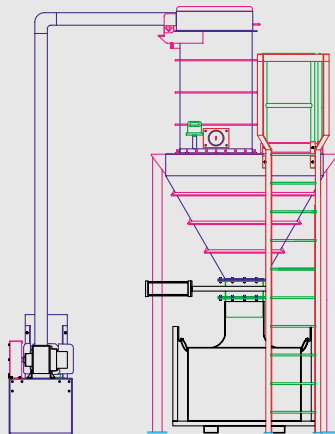

### Fork Truck Portable Vacuum Cleaner

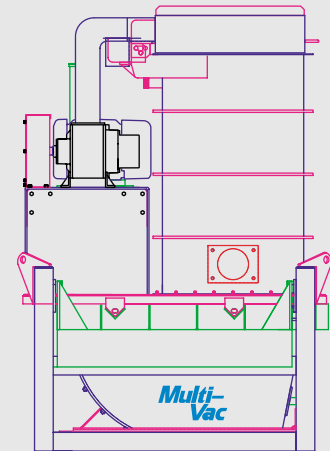

### Stationary Unit With Counter Weight Gate For Batching

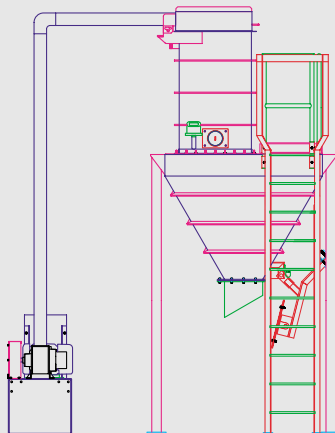

### Stationary Unit With Rotary Air Lock For Continuous Discharge

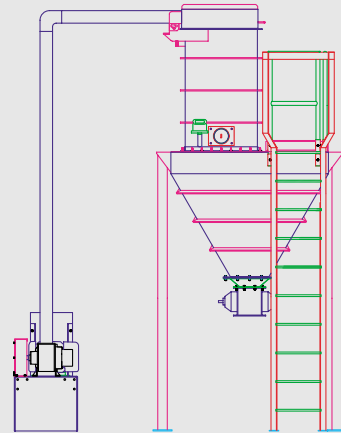

### Stationary Intercept Hopper With Rotary Air Lock

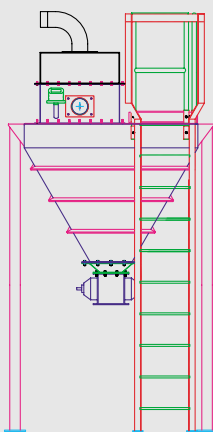

### Fork Truck Portable Intercept Hopper For Loading/Unloading

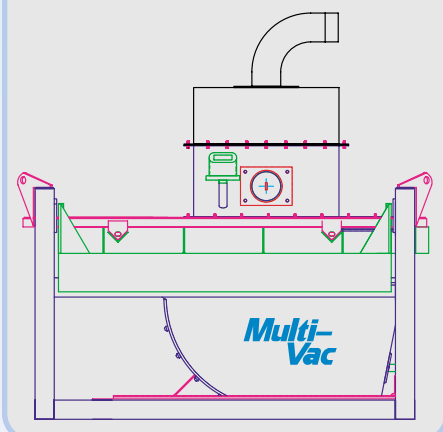

# Multi-Vac Super Mini Series



This compact vacuum loader dumps collected material into a tote box, **not on the floor as competitive machines do.** The Super Mini Series is offered with either positive displacement pump or regenerative vacuum pump.

## Standard Features

- 6 cubic foot dump hopper
- Electric elevation device—hopper dumps into a 34" high tote box
- Cartridge filter with reverse pulse jet cleaning system
- "No Tools Required" Access
- Hopper full shut down probe
- Flip top cartridge access cover
- Dual Inlets, dual inlet deflectors
- Casters

## Optional Features

- Positive Displacement Pump Models
- Regenerative Vacuum Pump Models
- See Table below

## Specifications

- Length: 62", Width: 31", Height: 64"
- Shipping Weight: 1,000 lbs.

## Electric Power

- All models available 230/460/3/60, 575/3/60, 380/3/50
- Models 3R/3PD available 220/1/60

## Positive Displacement Pump Models

Model	Horsepower	Air Flow	Hose Size
3PD	3	60 cfm @ 14" hg	1½"
5PD	5	85 cfm @ 14" hg	1½", 2"
7.5PD	7.5	180 cfm @ 14" hg	2", 2½", 3"

## Regenerative Vacuum Pump Models

Model	Horsepower	Air Flow	Hose Size
3R	3	90 cfm @ 6.5" hg	1½"
5R	5	90 cfm @ 8.5" hg	1¼", 1½", 2"
8.5R	8.5	155 cfm @ 9.5" hg	2", 2½", 3"
11.5R	11.5	155 cfm @ 10.5" hg	2", 2½", 3"



# Multi-Vac Mini Series



The compact Mini-Series is moveable completely assembled and will fit through an 8' door.

The 3/4 cubic yard hopper means less time travelling to dump material and more time working.

Plus any flowable material can be handled.

## Standard Features

- 3/4 cubic yard hopper
- "No Tools Required" Access
- Positive displacement vacuum pumps are V-belt driven for optimum performance
- Filter bags are reverse pulse jet cleaned on a continuous or demand (programmable) basis
- Hopper full shut down probe
- Flip top filtration access cover
- Dual Inlets, dual inlet deflectors
- Moveable (completely assembled) by a 4,000 lb. fork-lift truck
- No internal baffles or ledges to create bridging and retard the flow of collected material
- Fits through an 8' Door fully assembled

## Optional Features

- Cartridge filters
- Explosion proof electrics
- LP Gas or Diesel driven vacuum pumps
- Liquids handling probe
- Trailer mounted units
- Interceptor hoppers
- Power Cord Reel
- HEPA filters
- 2 cubic yard hopper

## Stationary Version

- The mini series is also available in a stationary design with a complete range of hopper sizes and discharge configurations.

Can be connected to a manifold or taken to a job.

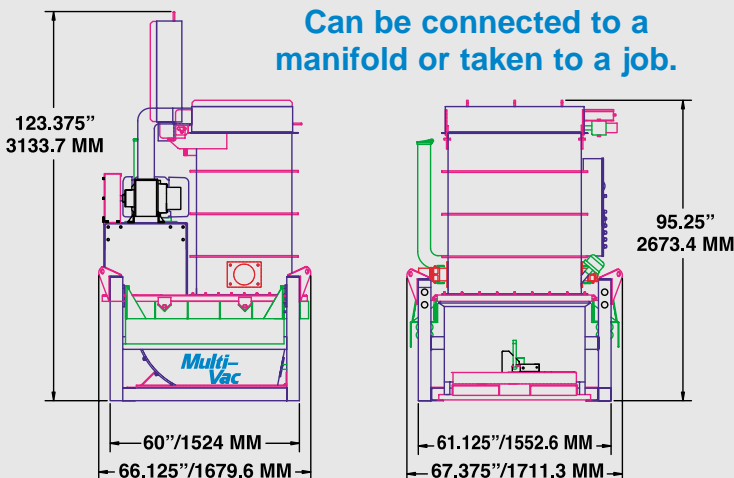

## Multi-Vac Mini Series Models

Model	HP	CFM @ Inches HG	Air/Cloth Ratio	Weight
Mini 1000	10	270@14	2.4	3,240 lbs.
Mini 1500	15	355@14	3.2	3,430 lbs.
Mini 2000	20	440@16	4.0	3,620 lbs.
Mini 2500	25	600@16	5.3	3,765 lbs.
Mini 3000	30	720@16	6.5	3,850 lbs.

# Multi-Vac Millennium Series



The new generation of vacuum loaders engineered to provide long service life with minimal maintenance attention! With a wide range of capacities available, there is a Multi-Vac Millennium to suit your application.

## Standard Features

- 2 cubic yard hopper
- "No Tools Required" Access  
Positive displacement vacuum pumps are V-belt driven for optimum performance
- Filter bags are reverse pulse jet cleaned on a continuous (programmable) basis
- Hopper full shut down probe
- Flip top filtration access cover
- Dual Inlets, dual inlet deflectors
- No internal baffles or ledges to create bridging and retard the flow of collected material
- Movable (completely assembled) by a 5,000-8,000 lb. fork-lift truck

## Optional Features

- Cartridge filters
- Explosion proof electrics
- LP Gas or Diesel driven vacuum pumps
- Liquids handling probe
- Trailer mounted units
- Interceptor hoppers
- HEPA filters

## Standard Portable Systems

- Vacuum units are supplied with a 2 cu. yd. fork lift truck type self dumping hopper and a heavy duty air lift stand. A complete range of nozzles, hoses and couplings are available from 1½" to 10" in dia.

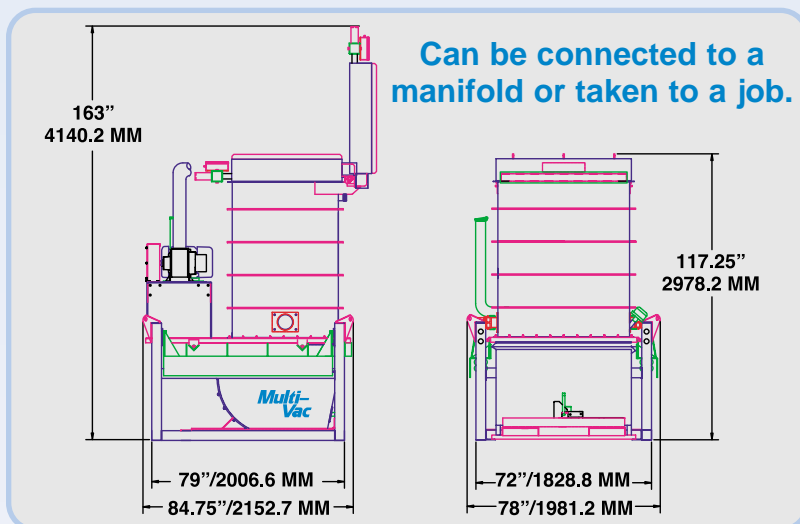

## Multi-Vac Millennium Series Models

Model	HP	CFM 16" HG	Air/Cloth Ratio	Weight
3000	30	720	2.5	4,900 lbs.
4000	40	860	3.0	5,225 lbs.
5000	50	1,250	4.5	5,575 lbs.
7500	75	1,550	6.1	6,100 lbs.

# Stationary Systems and Intercept Hoppers



A Multi-Vac Stationary System can power a manifold system throughout the entire plant. A Multi-Vac Intercept Hopper can be added to the vacuum line to collect reusable material.

## Stationary Systems

A Multi-Vac Stationary System can be used as a central vacuum cleaning system, batching, continuous discharge, loading or unloading.

- On ground controls for easy access
- 16 cubic feet to 16 cubic yard capacities
- “No tools required” filter/cage removal system
- Dual inlets
- Power a manifold system throughout the plant with multiple hose inlet points.

## Intercept Hoppers

A Multi-Vac Intercept Hopper can be used to reclaim picked-up material. Material drops out of the air-stream into the hopper. The remaining dust and fines continue on and are collected at the main unit.

- Stationary or forklift portable
- Can be installed in many configurations
- Hopper full shut down probe
- Standard and custom units available



## Power Packs™

- 10hp to 75hp
- Ease of service
- Electric, Diesel or LP Gas



## Stationary Series Models

Model	HP	CFM @ Inches HG	Air/Cloth Ratio
Mini 1000S	10	270@14	2.4
Mini 1500S	15	355@14	3.2
Mini 2000S	20	440@16	4.0
Mini 2500S	25	600@16	5.3
Mini 3000S	30	720@16	6.5
Mini 4000S	40	860@16	5.4
Mini 5000S	50	1,250@16	7.9
Mill. 3000S	30	720@16	2.5
Mill. 4000S	40	860@16	3.0
Mill. 5000S	50	1,250@16	4.5
Mill. 7500S	75	1,550@16	6.1

# Standard and Specialty Trailer Units



Both the Multi-Vac Mini and Millennium Series can be trailer mounted and equipped with electric, LP gas or diesel vacuum pump drives. We also design and build special trailer units for your unique needs.

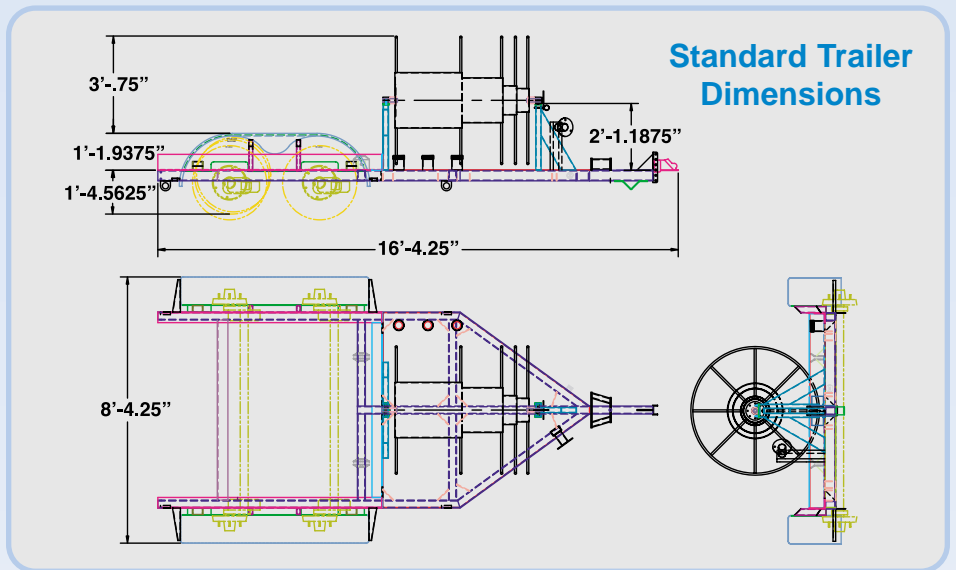

## Standard Features

- See Mini and Millennium Multi-Vac Description for Unit Specifications (pages 6 and 7)
- Trailers can be retrofitted to any of our existing units.

## Optional Features

- Hose Reel
- Nozzle Rack



## Conversions and Upgrades



For approximately half the cost of a new machine, we can replace an old-fashioned bags/cages or expensive cartridges with our “No Tools Required” filters/cages access and removal/ replacement system.

### Save Time and Money

Inspection, removal, and replacement of our filter/cages takes only minutes—not hours as in some other designs.

Conversion of the old machines involves removal of the filter housing and installation of a Multi-Vac filter system complete with reverse pulse valves and a programmable control module.

In addition to the machine cost savings there is also a considerable savings on operating cost.

### The Conversion Process

- 1) Complete disassembly, inspection, sandblasting and replacement of worn and damaged parts.
- 2) Motor testing for correct current draw and speed.
- 3) Vacuum pump inspected and tested at full vacuum.
- 4) New Multi-Vac V-Belt Drive added for maximum performance.
- 5) Control panel is reconfigured to the Multi-Vac system.
- 6) Replacement of gaskets, seals, etc.
- 7) After the re-assembly of the machine, a shop test is performed to ensure maximum performance.
- 8) Final painting is applied after all testing is completed/documentated.
- 9) The resulting machine has a “new” appearance as well as a like “new” performance.

**Do You Have A Tired Shaker Or Expensive Cartridge Vacuum Loader? Ask Us About A Multi-Vac Conversion!**



### Other Upgrades Offered

- Cartridge to Bag Upgrades
- Vacuum Pump Rebuilding
- Dust Collector Upgrades
- Control System Upgrades
- Conversion to Reverse Pulse Jet Filter Cleaning System

## Accessories



### Self-Contained Units

When electrical power is not available, Multi-Vac Units can be equipped with LP Gas or Diesel engines.

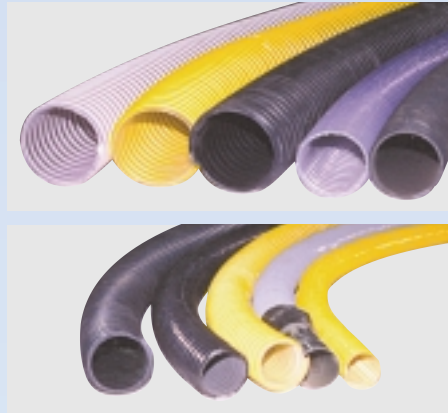

### Hoses and Couplings

A complete range of hoses and couplings are available from 1½" to 10" diameter.



### Nozzles

A variety of nozzles are available to handle an array of applications and materials.



### Lift Bale

Lift Bales are available for all Mini and Millennium Series Units. The framework of both Series are designed to be lifted.



### Hoppers

Add additional hoppers to increase operation uptime. Fork-Lift Truck Portable—3/4 yard and 2 yard models.



### Cartridges

Upon request, cartridge filters available for special applications.

### Other Optional Features

- Explosion Proof Electrics
- Liquids Handling Probe
- HEPA Filters
- Power Cord Reel
- Trailers can be retrofitted to any of our existing units.
- Interceptor Hoppers

### Custom Units

Custom units up to 300hp can be designed for your specific application. We offer complete design and engineering services.

### Rental Options

Many Models are available for rent on a short or long-term arrangement. Call the Factory for complete details.

### Service

We service what we sell. We carry a complete stock of parts to ensure your Multi-Vac Unit keeps running.

### Warranty

By using conservative design standards with all our components we have produced a machine which will have a superior operating life span and require minimum maintenance. Consequently a 2-year warranty is furnished with all Multi-Vac Systems.



## Industries Served

- Brick Manufacturer
- Foundry
- Steel Manufacturer
- Lime Manufacturer
- Nickel Mine
- Tire Manufacturer
- Pipe Manufacturer
- Tube Manufacturer
- Chemical Manufacturer
- Bakery
- Abrasive Manufacturer
- Copper Mine
- Cement Manufacturer
- Lead Smelter
- Tile Manufacturer
- Window / Door Manufacturer
- Charcoal Manufacturer
- Power Plant
- Chip Board Manufacturer
- Engine Manufacturer
- Insulation Manufacturer
- ReFactory Manufacturer
- Rubber Molder
- Gold Mine

## Materials Handled

- Abrasives
- Alumina
- Aluminum Scrap
- Asbestos
- Ash
- Bark
- Brick
- Carbon Black
- Catalysts
- Cement
- Ceramic Particles
- Cereals
- Chemicals
- Clay
- Clinker
- Coal
- Cullet
- Dust
- Fertilizer
- Flour
- Grains
- Lead Oxide
- Limestone
- Liquids
- Metal Chips
- Mill Scale
- Mineral Wool
- Ore Pellets
- Oxides
- Paper
- Plastic Pellets
- Refractories
- Rocks
- Sand
- Sawdust
- Shot and Grit
- Slag
- Slurries
- Vermiculite
- Wood Chips

## Applications

- All Process Pneumatic Vacuum/Pressure Systems
- General Plant Cleanup
- Material Recovery
- Bin Loading/Unloading
- Central Manifold Systems
- Scaling/Batching
- Spills
- Bulk Loading/Unloading
- Pharmaceutical
- Machining & Milling
- Belt Loading
- Belt Spillage Cleanup
- Dump Truck Loading
- Roof Pea Gravel Removal
- Hazard Cleanup
- Water & Slurry Removal and Recycling
- Low Headroom Mining
- High-Temperature Materials
- Special Engineered Applications
- Plus many more

## Company History

President and Owner, Wally Haag has worked in the Industrial Vacuum Field since 1974. He first started out in the manufacturing area, working his way into Field Service Management, and New Product Development. In 1980, Mr. Haag purchased half ownership of M&W Shops, Inc. (a custom metal fabrication shop) where he continued to use his experience to manufacture New Weldments and Special Vacuum Equipment. In 1990, Mr. Haag took full ownership of M&W Shops. At that time, the decision was

made to use his engineering experience of Heavy Vacuum Equipment and Metal Fabricating to design a new maintenance friendly product line of Vacuum Cleaners, Loaders and Conveyors which is now Multi-Vac. Since that time, Multi-Vac has become a well known and respected name in steel mills, foundries, cement and brick plants as well as in the mining, plastic, rubber and chemical industries. Successful installations are in use from the East Coast to the West Coast, South America, Canada and Mexico.



21209 Durand Avenue • Union Grove, WI 53182-9711  
Tel: 262-878-0366 • Toll-Free: 1-800-640-4213 • Fax: 262-878-0368  
[www.multivacinc.com](http://www.multivacinc.com)

**RENT • LEASE • PURCHASE**